



**INSTALLATION INSTRUCTIONS
AND
OPERATION MANUAL**

ELBP

Extended Life Battery Pack for PBU Power Backup Unit

CONTENTS

IMPORTANT INSTALLATION INSTRUCTIONS.....	2
SPECIFICATIONS.....	3
INSTALLATION INSTRUCTIONS.....	3
WIRING INSTRUCTIONS.....	3
WIRING DIAGRAM & CONNECTING PROCEDURES TO PBU.....	4
BATTERY SPECIFICATION & CONNECTIONS.....	5
MAINTENANCE INSTRUCTIONS.....	6

IMPORTANT INSTALLATION INSTRUCTIONS

WARNING – To reduce the risk of death or serious injury to persons:

1. READ AND FOLLOW ALL INSTALLATION INSTRUCTIONS.
2. Make sure the available power supply to be connected to the device is of the same voltage, frequency and phase as indicated on the nameplate of the device.
3. Read and understand the wiring diagram of the device and any other equipment to be connected to the device.
4. Always disconnect power whenever installing or servicing the device.
5. All wiring must be permanent and comply with National Electrical Code (NEC) and local code requirements.
6. For “Indoor Dry” location use only.

WARNING

Disconnect power before proceeding with any wiring.

SPECIFICATIONS

ELBP Extended Life Battery Pack	
Output Voltage	36VDC
Batteries	12VDC, 17.2Ah x 3
Applicable Power Backup Unit Model	PBU-150-11
Net Weight (including batteries)	58lbs / 26kgs

Notes:

1. This battery backup unit is a 36VDC supplemental power supply to an AC power backup unit to maintain motor operator functionality during AC power loss and is intended to be used with the model shown in the specifications.
2. This device must be connected to power source for at least 12 hours to fully charge batteries.

INSTALLATION INSTRUCTIONS

1. Structure supporting device must be adequate for weight of device.
2. Attach panel to wall using suitable fasteners for mounting conditions, such as
 - Expansion or sleeve anchors into concrete
 - Sleeve anchors into masonry
 - Self-tapping screws into steel framing
 - Lag screws into wood framing

On drywall construction, it may be necessary to bridge across studs with a suitable support system.

WIRING INSTRUCTIONS

1. Do not install any wiring or attempt to run this device without checking the wiring diagram located on the inside of the control box cover.
2. Do not turn on power until you have finished making all power and control wiring connections.
3. Do not run power and control wiring in the same conduit.
4. Any wire connected to the control panel must be protected by conduit or other means to ensure the safety and permanency of the wiring.
5. Use copper wire inside the control panel.

WARNING

Disconnect power before proceeding with any wiring.

WIRING DIAGRAM & CONNECTION PROCEDURES TO PBU

BATTERY PACK FOR PBU

12VDC , 17.2AH × 3

SCAN FOR
COLOR VERSION



PBU-B-02

WARNING : DISCONNECT POWER BEFORE WIRING.

CONNECTING PROCEDURES :

STEP 1 : CONNECT TWO WIRES TO TERMINALS CN4 (+,-) ON THE BATT PCB IN PBU BOX.

STEP 2 : PLUG IN THREE (3) BATTERY CONNECTORS (YELLOW) IN THE BATTERY PACK.

STEP 3 : CONNECT THE RED CONNECTORS BETWEEN THE PBU AND BATTERY PACK.

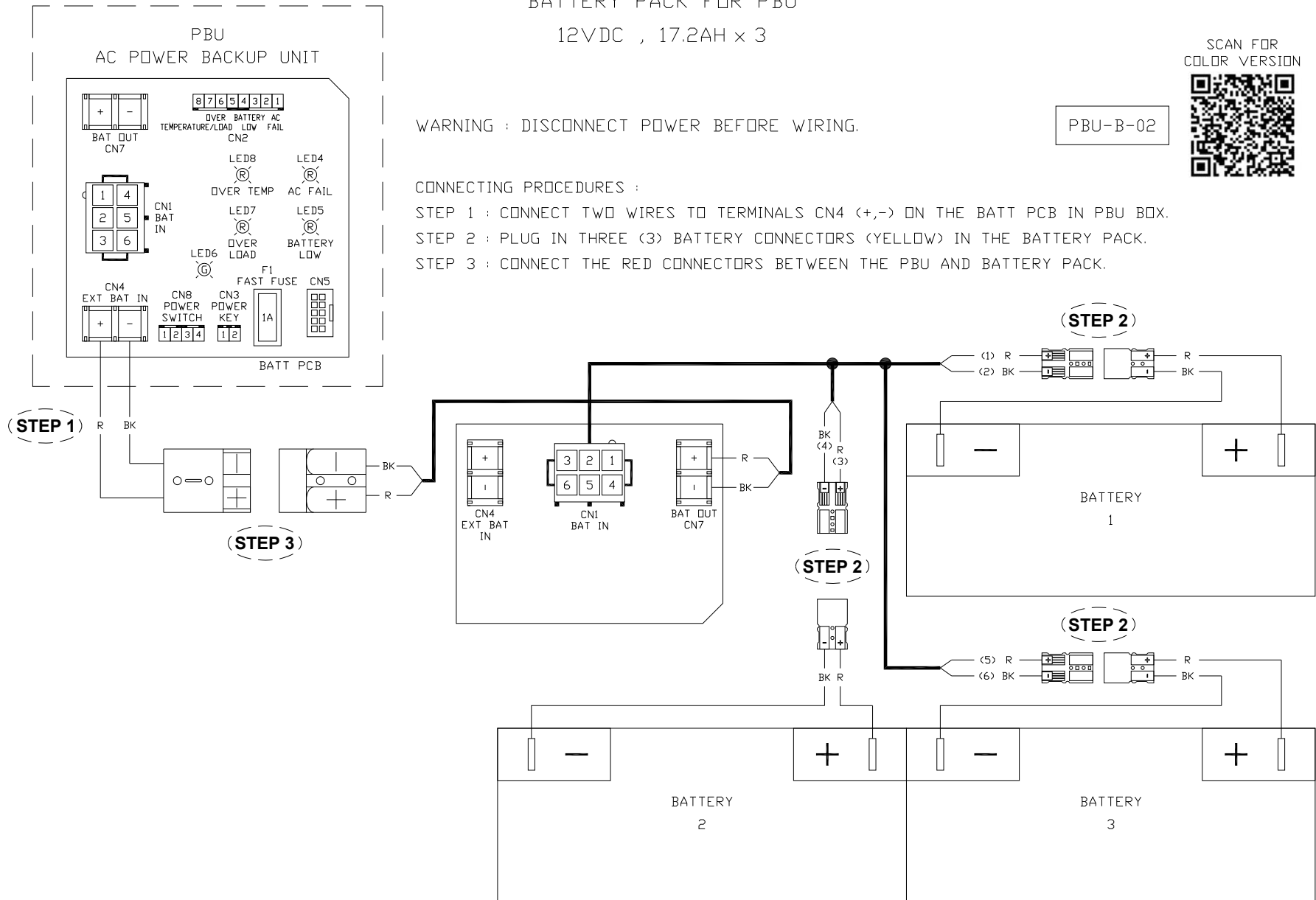

2022.09.02

BATTERY SPECIFICATION & CONNECTIONS

1. Specification:

Type	Battery Rating
Sealed Lead Acid Rechargeable Battery	Three (3) 12VDC, 17.2Ah

2. Connections:

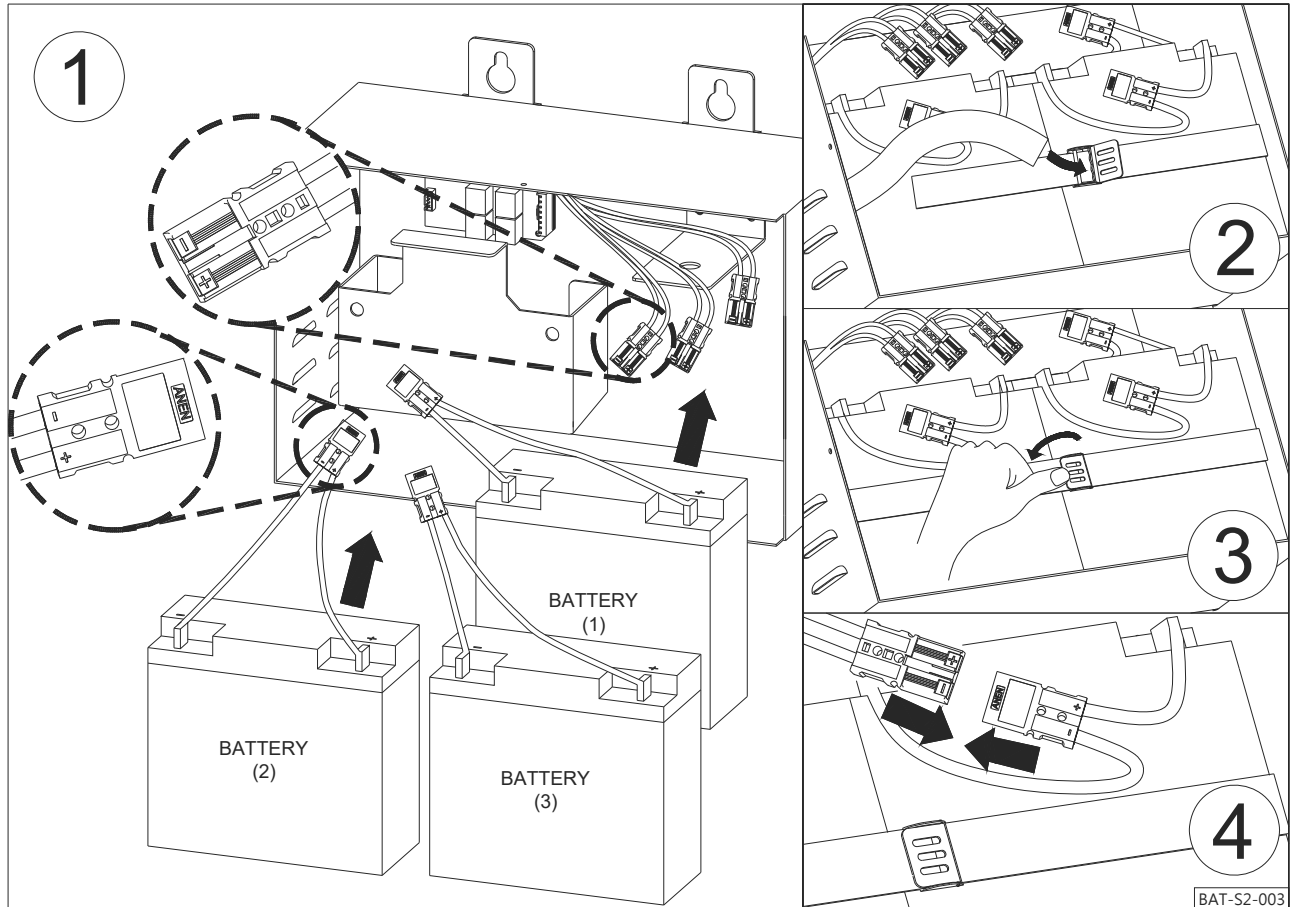

MAINTENANCE INSTRUCTIONS

WARNING

Disconnect power before servicing.

Check the following items at the intervals listed:

CHECK LIST	DESCRIPTION	EVERY 6 MONTHS
Fasteners	Check & tighten as required	●
Battery	Check battery voltage (must be higher than 31VDC)	●

- ❖ Inspect and service whenever a malfunction of the device or equipment connected to it is observed or suspected.
- ❖ Before servicing, always disconnect powers to the device.
- ❖ Replace fuses only with those of the same type and rating.
- ❖ All replacement parts must be compatible with those originally provided. Consult manufacturer for replacement parts.
- ❖ Change batteries every 2 years or when they fail to charge, whichever comes first. The change procedure is shown in the battery specification & connections section.

WARNING

Do not place hands or tools in the device when the power is connected or when testing the device or equipment connected to it. Always disconnect power before servicing or adjusting the device or other equipment connected to it.