

# LAWRENCE

## FIRE DOORS

# LAWRENCE

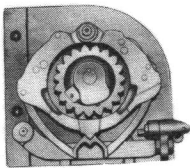
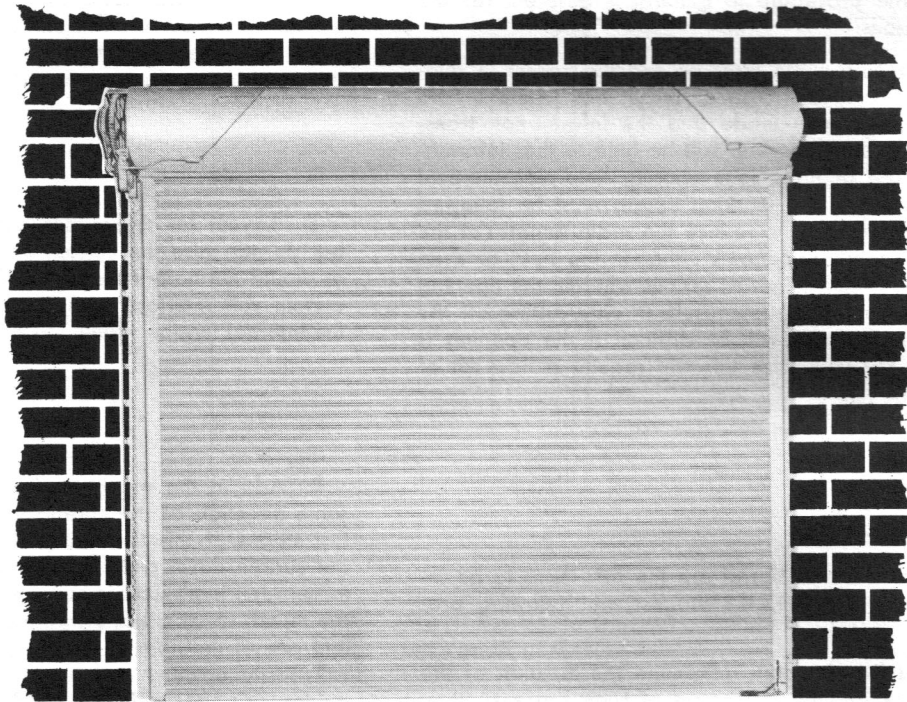

MANUAL  
SEE ABOVE TABLE

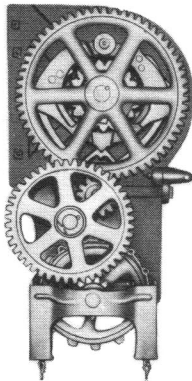

Model 723  
Multiple Reduction  
Chain

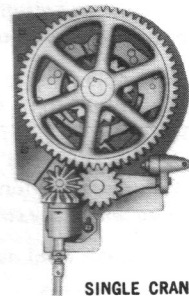

SINGLE CRANK

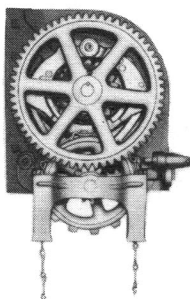

Model 711  
Single Chain

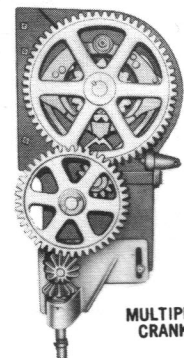

MULTIPLE  
CRANK

### STEP 1

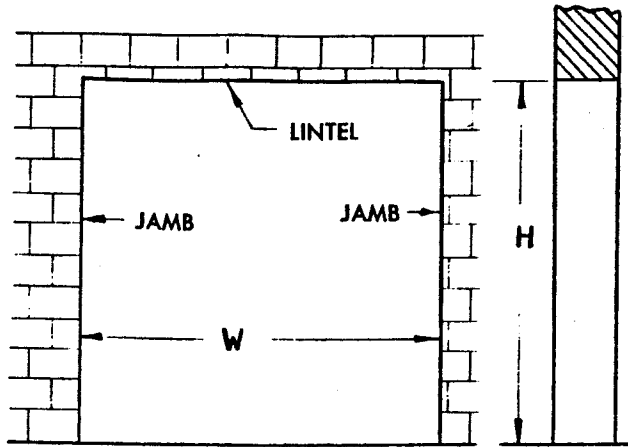

Measure the opening width & height

### STEP 2

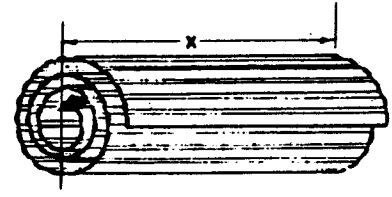

Measure the curtain (include the end clips)

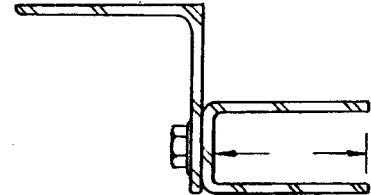

Measure the channel depth.

### STEP 3

#### Depth of Clearances

Channel Depth	Clearance Each Side
2" .....	3/8"
2 1/2" .....	1/2"
3" .....	3/4"
3 1/2" .....	1"
4" .....	1 1/4"
4 1/2" .....	1 1/2"

### STEP 4

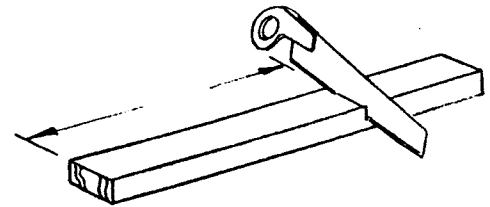

Cut a stick the width of the curtain + the clearances from the table.

Eg. 8'-4" + 1/2" + 1/2" = 8'-5" stick

### STEP 5



#4. When mounting the guides and using expansion bolt shields to do so, we recommend the following procedure: Place all the bolts through the holes in the guides and screw on the shields, then placing the guide on the wall — the shields are fed into the previously drilled holes. Push the shields into the holes as far as possible and then hit the bolt head with a hammer once or twice. Tighten the bolts as much as possible and again hit with the hammer and re-tighten. This can be repeated until the shield is completely in the hole and tight. Make sure that the holes are deep enough for the entire shield before starting. The above procedure is found to be superior since picking up the thread of the shield after it is in the hole is a long and difficult job.

## STEP 6

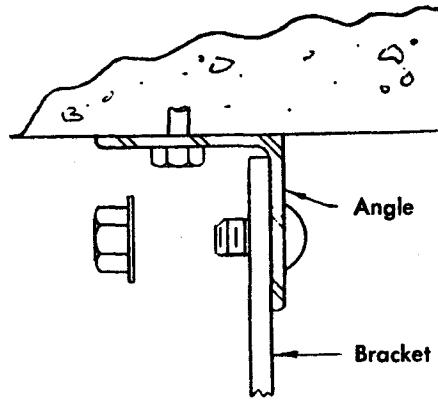
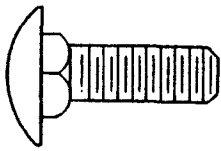

Locate the carriage bolts and nuts. These will be used to secure the brackets to the upper part of the guides. The brackets will always be mounted to the outside of the angle with the bolts going from inside the angle and then

thru the bracket to leave a smooth surface inside the housing. In the case of manually operated Model 714, always put up bracket number 14 WL first on the left guide. On the other models, the last two letters after the number tell which.

## STEP 7

TOWARD WALL

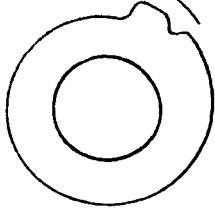

Slip the collars on to the barrel and lock them in place to match the spacing of the holes (slotted) in the top slat of the curtain. Eccentric always faces wall.

## STEP 8

Remove the three loose casting from the "Spring" end of the barrel. This end shaft will fit through the hole of the previously mounted casting (bracket).

Place the remaining power-Governor bracket on the barrel shaft opposite the end with the special castings visible.

## STEP 9

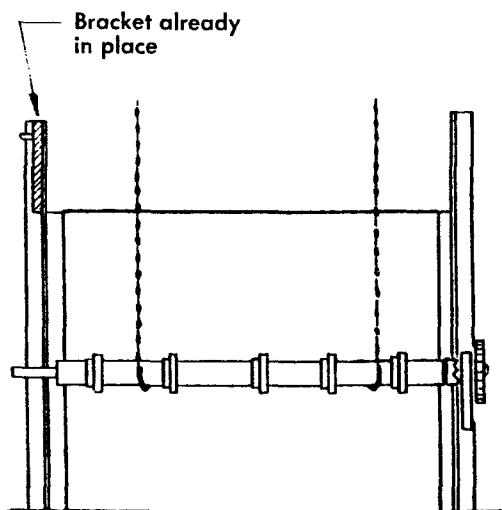

You are now ready to hoist the barrel assembly into place. Chain or rope falls are generally best for doors too large to place up by hand. Slip the exposed shaft into the bracket already in place, and secure the other bracket to its guide as shown in STEP 6. After barrel is in place and brackets secured, rotate the barrel to be sure it is free moving.

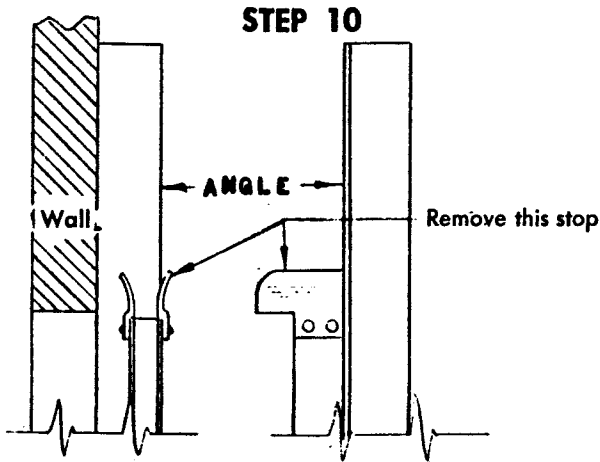

Remove the large formed stop at the top of each channel. Check the roll of the curtain so that the angles which form the **BOTTOM** rail are on the **INSIDE**, and that the curved part of the slat is toward the outside.

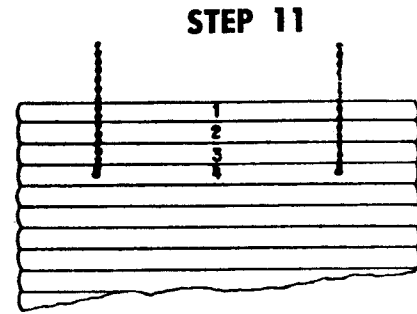

Fasten the falls to the curtain by punching a hole with a drift pin **FOUR** slats from the top of the curtain and several feet in from each side. Hoist the curtain up in back of the barrel with the 3 loose slats hanging over the top. Center the curtain so that the clearance will be equal when in the guides.

### STEP 12

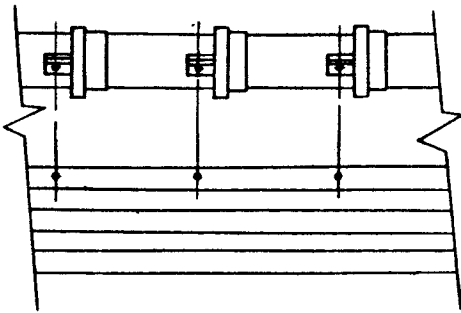

Attach the curtain to the collars by driving a drift pin through the slat over the hole in the collar. You will find in the box the bag with the bolts and nuts.

When the curtain is in place, check that it hangs true. Should this not be the case, loosen the set screws of the collars and slip them around the barrel until the curtain

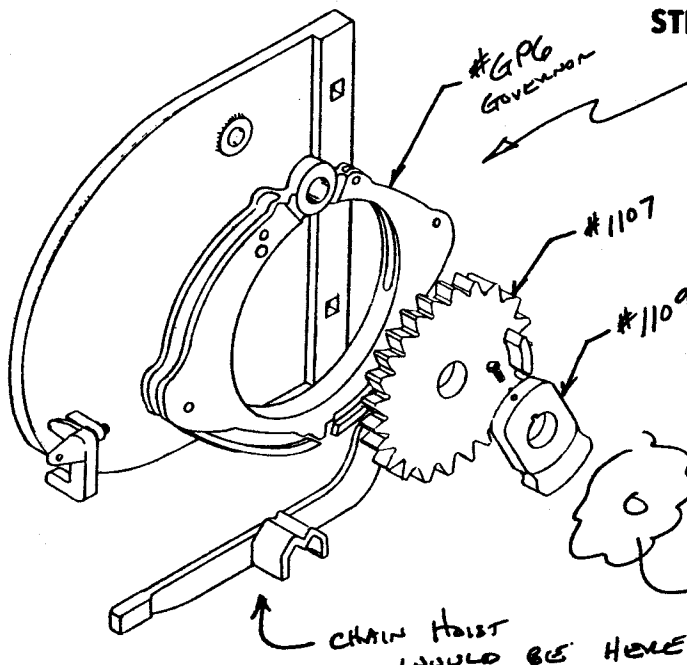

*PUSH UP*

For Model 714: There is no main gear to push up model but an engagement lug takes its place. The governor ratchet casting (GG6) must go on the shaft first with the numbers facing the bracket. The loose large washer (a spacer) is put on next. Last is the Governor engagement lug part fitting into the groove of the governor ratchet. The lug is held with a 1/4" key and set screw.

For models with main gear (711, 723, 727) assemble the main gear to the shaft with the lug section facing the governor engagement ratchet and washer as mentioned above.

A spring is sent with the above mentioned parts which is so placed to hold the governor ratchet with the lug or gear lug in such a way that the governor is delayed approximately one (1) turn of the main barrel and shaft.

*MAIN GEAR WOULD BE NEXT #115 OR 515*

*CHAIN HOIST SHOULD BE HERE*

### STEP 14

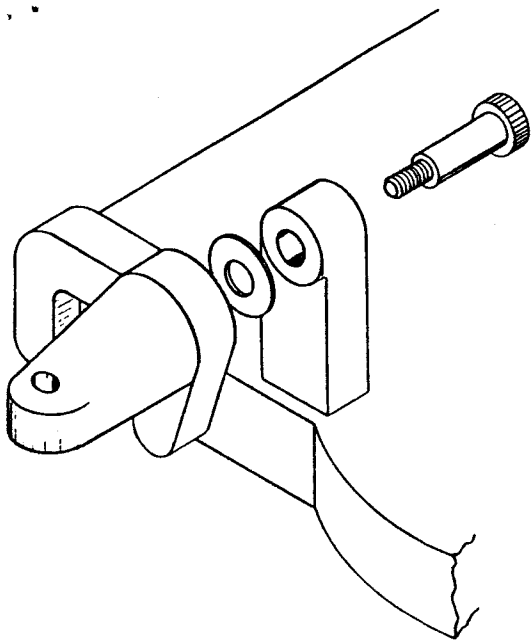

When shipping our fire doors, it is necessary to remove parts 1006 and 1007 from the brackets. The purpose of this picture is to show the reassembly of the parts in the field.

### STEP 15

Find These Parts

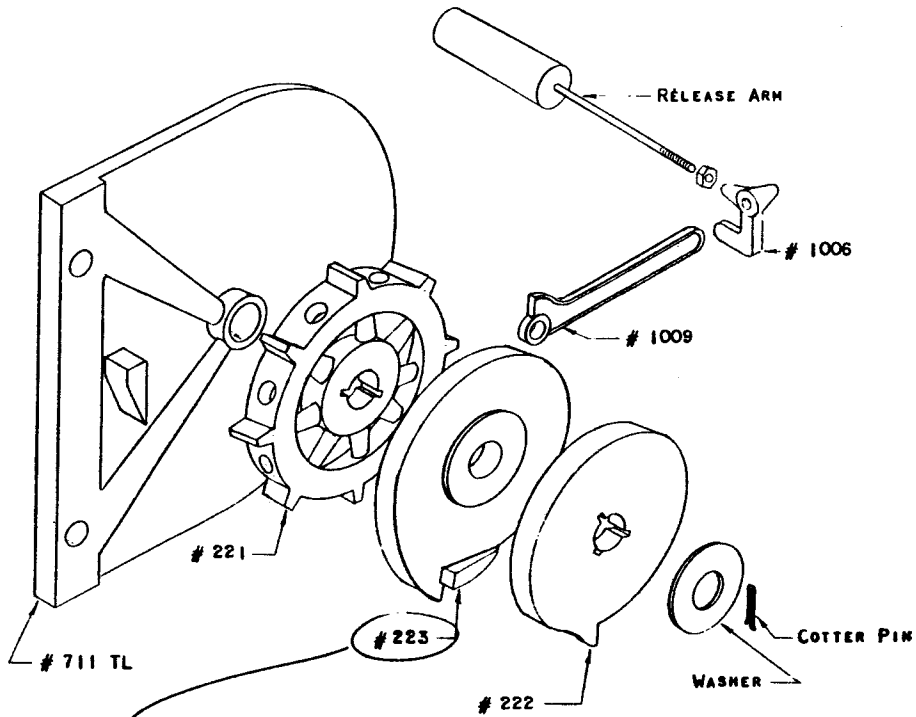

#223  
ON LEFT  
HAND  
OPERATED  
DOORS

#224  
ON RIGHT  
HAND  
OPERATED  
DOORS

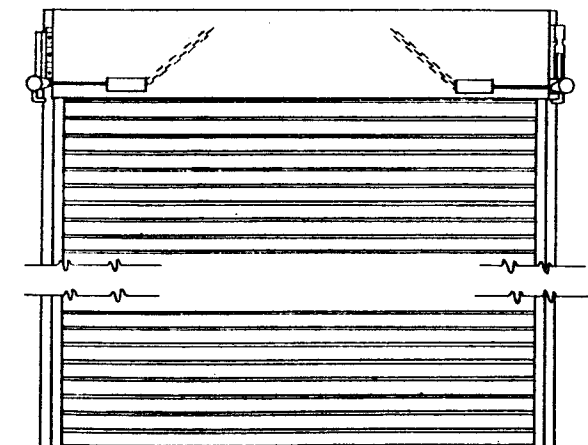

## STEP 16 A

(to be used on multiple eccentric units)

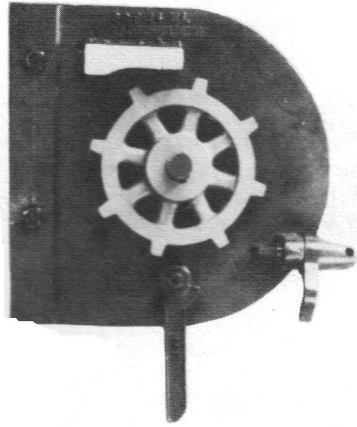

STEP #1. After completing the installation of the barrel and brackets. Install the curtain to the collars making sure that all the set screws are tight. Roll the curtain up to the full open position and wedge it to prevent closure. Now, place the winding wheel into place and add the key to lock same to the shaft.

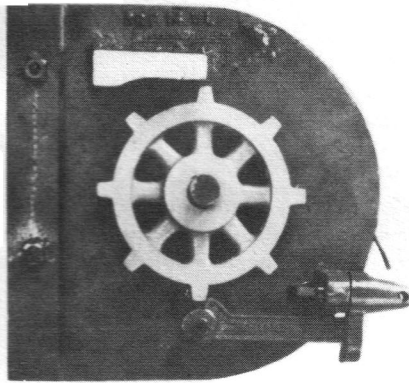

STEP #2. With the short key in place, you may now begin to introduce the wind into the spring. Several turns are necessary until the curtain will loosen the wedge and indicate that the weight of the curtain is balanced to some degree. Lock the winding wheel with the trigger mechanism omitting the fusible links only.

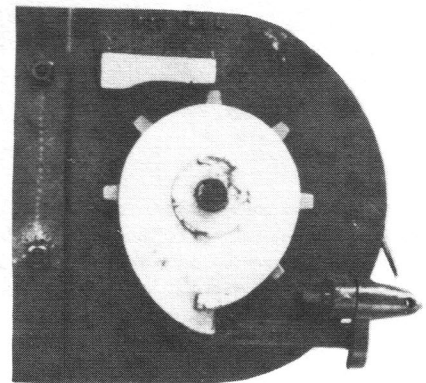

STEP #3. The multiple eccentric units can be identified since there are no teeth on the winding wheel. On this type, you will next add the large eccentric which does not have any keyway in the bore. This part is mounted with the secondary stop outward.

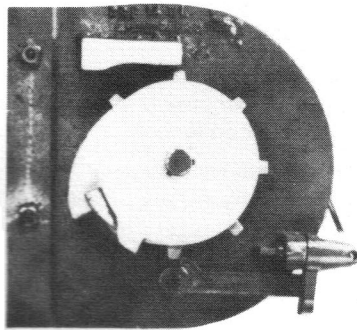

STEP #4. Next is the small eccentric. You place it in the position shown in the photo. This part has three possible settings for close adjustment. The eccentric train should be turned as far as possible in the same direction as you turned the winding wheel and then locked by aligning with the nearest keyway with the other short key.

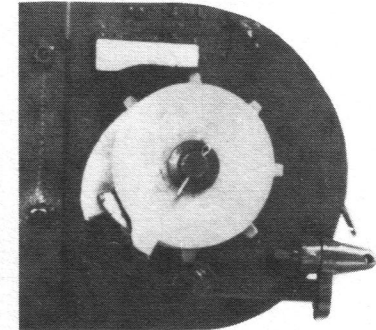

STEP #5. Add the washer and cotter pin to retain the units in position. You may now test the unit after opening the cotter pin. Readjust to suit for desired operation. The units generally will be best balanced to just stay open. After testing, you can add the omitted fusible links to the trigger.

## STEP 16 B

(to be used on single eccentric units)

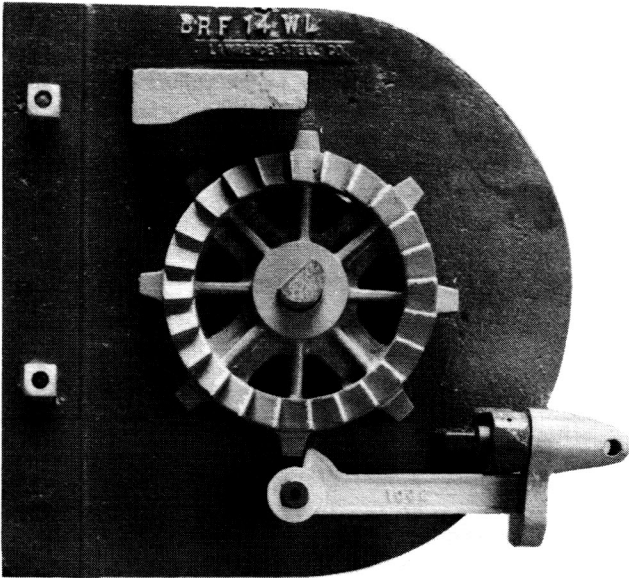

STEP #1. After landing the barrel with the brackets and attaching the curtain to the collars, roll up the curtain to the open position. Now set onto the spring shaft the winding wheel pictured at left. Rotate same downward and away from the wall to introduce the spring tension. After the desired amount of tension is applied, set the trigger mechanism omitting the fusible links only.

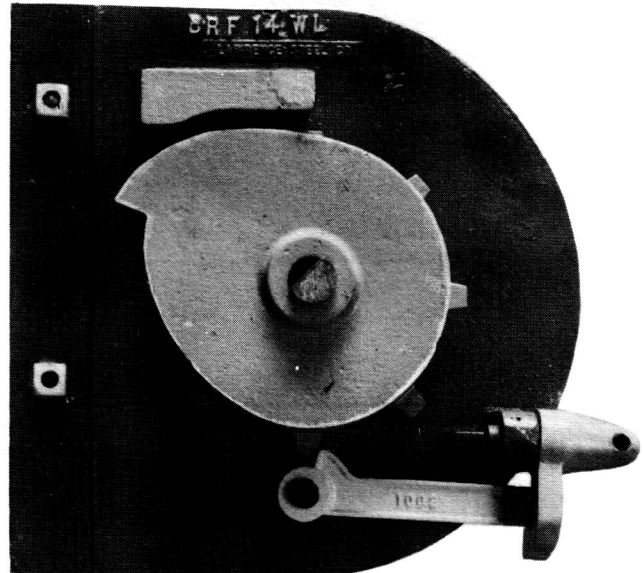

STEP #2. On these single eccentric assemblies, add the eccentric with the teeth engaged to the winding wheel in the position pictured here. Do not test the door until step #3 is completed.

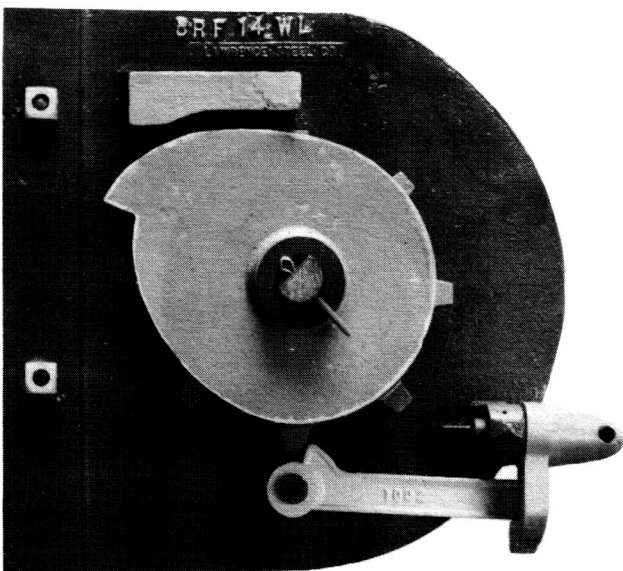

STEP #3. Place the retaining washer and cotter pin in the proper places. Never test a fire door without these retaining parts in place and locked.

After testing to determine proper spring tension for both service and fire operations, insert the fusible links into the system.