

Installation Instructions**IMPORTANT NOTES**

- The NMPE is intended to be **installed near the top of the guides on PG and PT High Performance Grilles** to provide **entrapment protection in the OPEN direction**. It is not to be used as an entrapment protection device in the closed direction on UL325-2010 compliant operators with provisions for monitored sensing devices. If the NMPE is being used for other purposes on other operators, refer to the installation instructions for that equipment.
- The NMPE sensor has a range of up to 45 ft.
- It is intended for use in indoor or outdoor applications in temperatures between -4 and 131° F.
- This is a relay output sensor and must be connected to the HGH operator provided with PG/PT High Performance Grilles as follows:
 - Connect **grey** (NC) and **white** (COM) wires to **TB6**, terminals **1** and **2** (labeled as open sensing device)
 - Connect **brown** and **blue** (non-polarized) wires to **TB6**, terminals **8** and **9** (24VAC)
- LED indicators show when power is on (red) and when sensor and reflector are properly aligned (yellow). (*Alignment can be adjusted by rotating/pivoting mounting brackets.*)
- A sensing range adjustment knob is under the top cover of the sensor that can be used to strengthen or weaken the infrared signal. (*Factory default setting is MAX and may need to be reduced at shorter distances for proper sensitivity.*)

PARTS LIST

(4) 1/4"-20 x 3/8"
PAN HEAD SCREWS

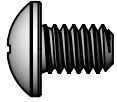

(4) 1/4"-20 WING NUT



(1) #8-32 WING NUT



(4) SRPE BRACKETS

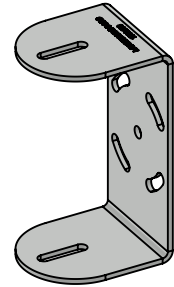

(4) 1/4"-20 x 5/8"
HEX HEAD BOLTS

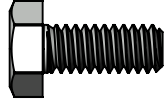

(4) 1/4" FLAT WASHERS

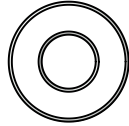

(3) #8 FLAT WASHERS



(4) 1/4"-20 x 3/4"
SQUARE NECK
CARRIAGE BOLTS

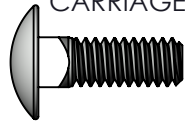

(4) 1/4"-20 FLANGE NUT



(2) M3 HEX NUT



(2) M3 x 35MM
PAN HEAD SCREWS



(1) REFLECTOR



(1) REFLECTOR HOOD

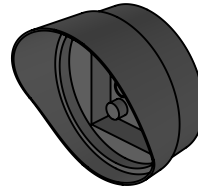

(1) E-936-S45RRGQ
SENSOR



(1) #8-32 x 1-1/2"
PAN HEAD SCREW

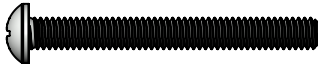

MOUNTING CONFIGURATIONS

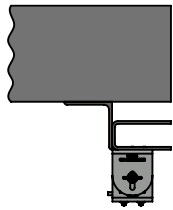

GUIDE MOUNT
(STANDARD)

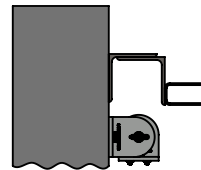
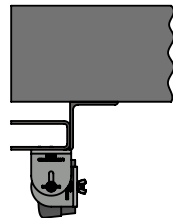

WALL MOUNT

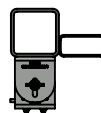
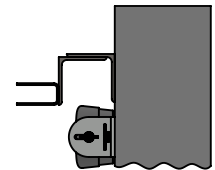

TUBE MOUNT

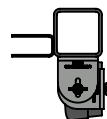

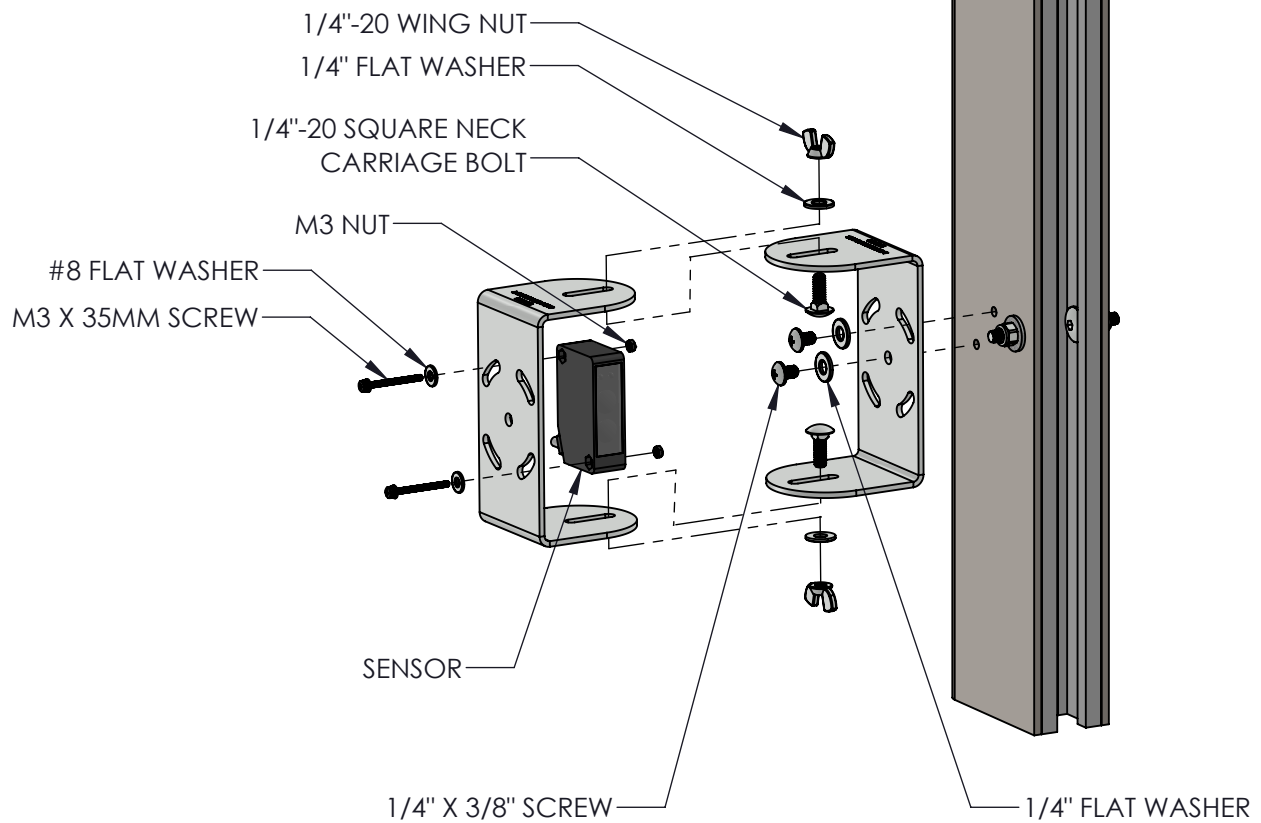
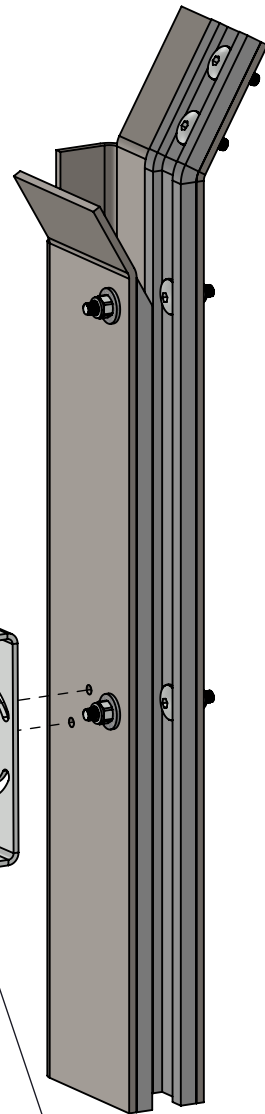
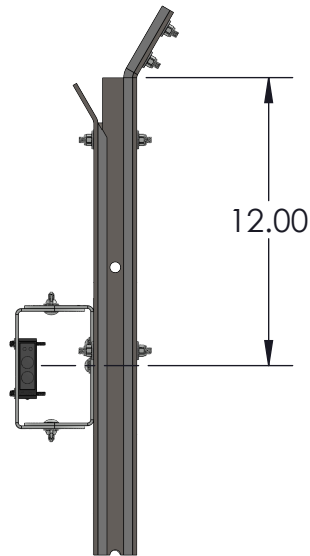

SENSOR SIDE

NOTES:

1. Sensor should be located on side of door where operator is located.
2. Mounting for LH operator as shown - RH is opposite.

